



DSD 36K LP CRANE BODY

15,000 - 19,500 Lb. G.V.W.R. Chassis

DSD SPECIFICATIONS	MODEL		
	DSD 84	DSD 108	DSD 120
Body Length	132"	156"	168"
Overall Width	96"	96"	96"
Front Height	42"	42"	42"
Rear Height	39"	39"	39"
Floor Width	49.5"	49.5"	49.5"
Compartment Depth	22"	22"	22"
Floor to top of Compartment	24"	24"	24"
Front Compartment Length	29.5"	29.5"	38"
Second Compartment Length	29.5"	29.5"	28.5"
Third Compartment Length	N/A	22"	28.5"
Horizontal Compartment Length	48"	48"	48"
Rear Compartment Length	26"	26"	26"
Optional Oxy/Ace Compartment Height	60"	60"	60"
Approximate Base Body Weight	2750	3270	3540

Our Promise To You:
" No Compromise"
 in Providing the
Very Best Equipment
 Available !

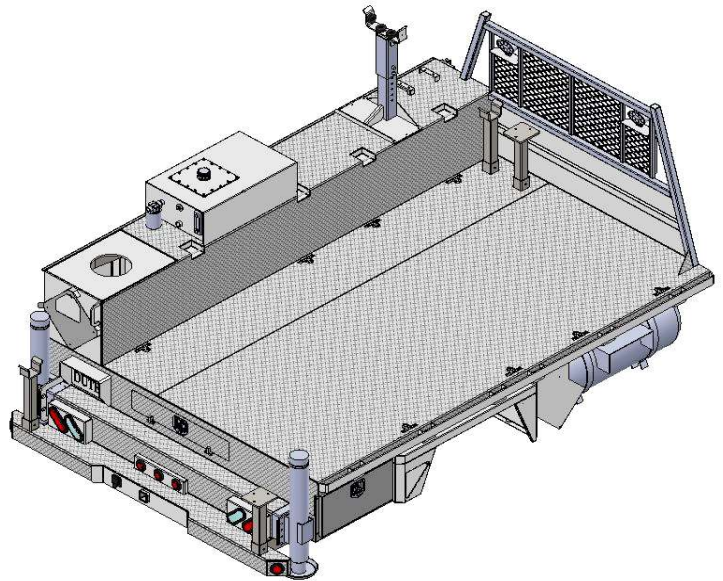
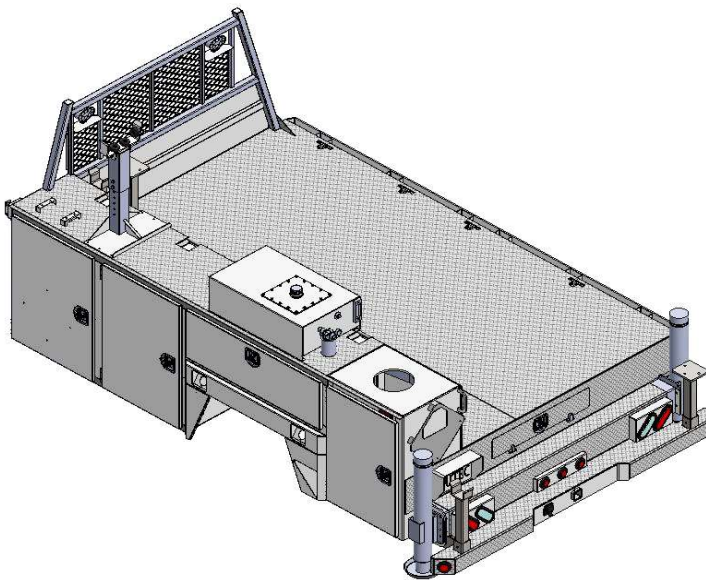
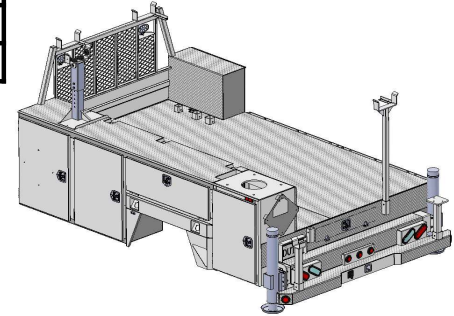
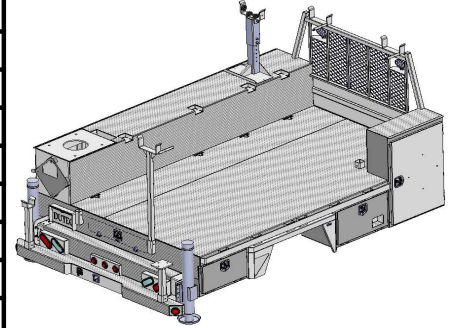

DSD 84 LP CRANE BODY
 WITH LP FUEL SUPPLY TANK UNDER PASSENGER FRONT SIDE

For Standard Features and Options See Reverse Side

L. P. Crane Body Specifications

- * **Body Subframe: 10.125" X 3/16" Crossmembers, 10 Ga Longitudinal Floor Reinforcement 3/16" Torsion Box Subframe for Rigidity**
- * **Floor: 1/8" Treadplate**
- * **Compartment Tops and Rears: 1/8" Treadplate**
- * **Crane Compartment: 3/8" H.R. Steel with 1/2" H.R. Top Plate and 4X3X 1/2" angle reinforcement. Completely open for Storage**
- * **Major Body Components: 12 Ga. and 10 Ga. H.R.P.O.**
- * **Body Designed With Appropriate Material Eliminating Overlays with Rust Pockets**
- * **Superior Weather Tight Double Panel Galvaneal Doors**
- * **Automotive Type Replaceable Bulb Rubber Seals Over Center Spring Loaded Door Restraints**
- * **3 Point Stainless Steel T-handle Latches Greaseable XHD Hinges with 5/16" Stainless Steel Pins.**
- * **Placard Brackets and Mounting Locations on Front, Both Sides and Rear of Body per DOT Standards.**
- * **Spring Mounting Kit**
- * **20" Deep L H Comps., 14" R H Comp.**
- * **Die Formed Ribs in Front Bulk Head**
- * **Rear Access Shovel box; 72" Deep**
- * **Recessed Tank Tie Downs Located in Floor and the Top of Side Pac.**
- * **All exterior Welds are Continuous, Fully Penetrating Welds.**
- * **No Caulking is used on these bodies.**
- * **HD Shelf Support Strips that hold shelves where You put them. Even on the Roughest Road**
- * **A Factory Installed Wiring Loom is Provided with each Crane Body**
- * **Stop, Turn, Tail Lights are Sealed Beams**
- * **Each LP Crane Body is Thoroughly Cleaned and Phosphatized Prior to the Application of 1 1/2 Mils of Sikkens Plural Component Grey Epoxy Primer**
- * **Fire Extinguisher Mounted on Dr. Front Side Pac**

OPTIONAL EQUIPMENT ALL MODELS

- * **Drawer Storage Units Mounted on 270 lb. Accuride Slides available for any compartment.**
- * **Material Storage Hooks for storage of Ropes, Cables, Cords, etc. These are available in Fixed, Swivel, and Sliding Swivel arrangements.**
- * **60" Tall Vented Oxygen / Acetylene Storage Compartment available in D - 1 or P - 1. The Compartment comes complete with Reinforced Floor with Bottle Retention Rings, Bottle Tie Downs, Gauge and Torch Holders, and a Hose Rack.**
- * **Underbody Concrete Block Storage. Stores 4 4x8x12 Blocks Used For Installation of Tanks.**
- * **Adjustable Shelves and Anti-rattle Dividers**
- * **Theft Deterrent Master Locking System**
- * **Cushioned Adjustable Boom Rest (shipped loose)**
- * **Hydraulic Crane Prep Package**
- * **Compartment Lights**
- * **HD Step Bumper**
- * **HD Step Bumper with Recessed 2" Ball Plate**
- * **HD Step Bumper with Recessed Pintle Hitch Plate**
- * **Manual Out and Down Outriggers with Spring**
- * **Outriggers with Spring Retract Legs.**
- * **Header with Work Light Brackets (no lights)**

**Outriggers Must Be Used On All Models
When Operating Crane!**

Authorized Distributor :

**For the name of your nearest
Dutec distributor call
903-868-1917**

Sherman, Texas